

M:\Operations\Dept BC\Projects\2020\04-20-0028 Ingleswood Care Centre Pre App\4.0 Analysis & Design\4.1 ACAD\1. Overall Site Design\04-20-0028 Ingleswood - Site Design Review_AT_V02-1.dwg
 2021/09/23 14:59, Plotted by Nathan Birk

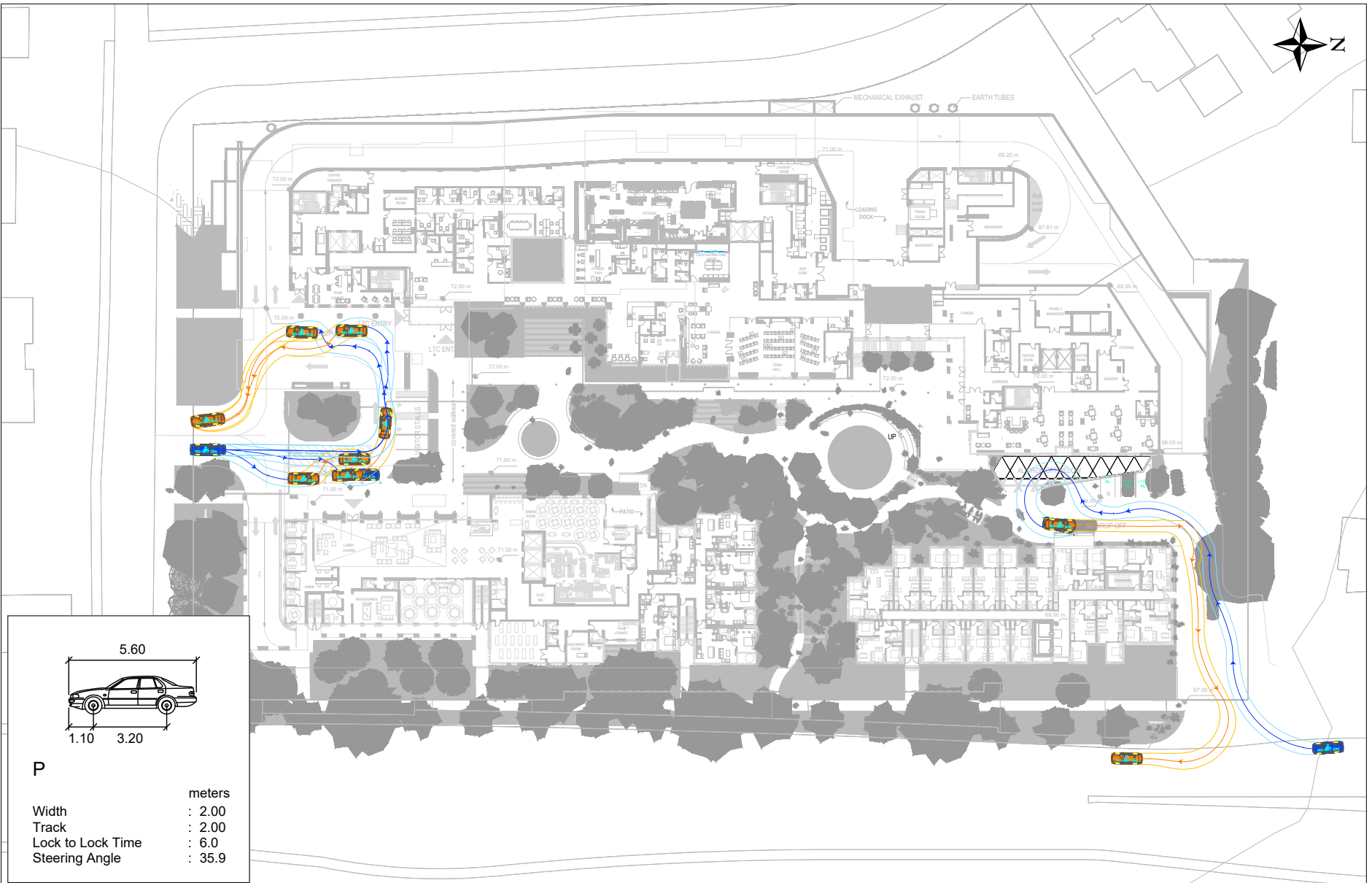

P

	meters
Width	: 2.00
Track	: 2.00
Lock to Lock Time	: 6.0
Steering Angle	: 35.9

[Based on Drawing A2-03 from ZGF dated 2020-04-01]

[Issued for Discussion; not for Construction]

Exhibit 4.8 Pick-Up/Drop-Off Stalls



M:\Operations\Dept BC\Projects\2020\04-20-0028 Ingleswood Care Centre Pre App\4.0 Analysis & Design\4.1 ACAD\1. Overall Site Design\04-20-0028 Ingleswood - Site Design Review_AT_V02-1.dwg
 2021/09/23 14:59, Plotted by Nathan Birk

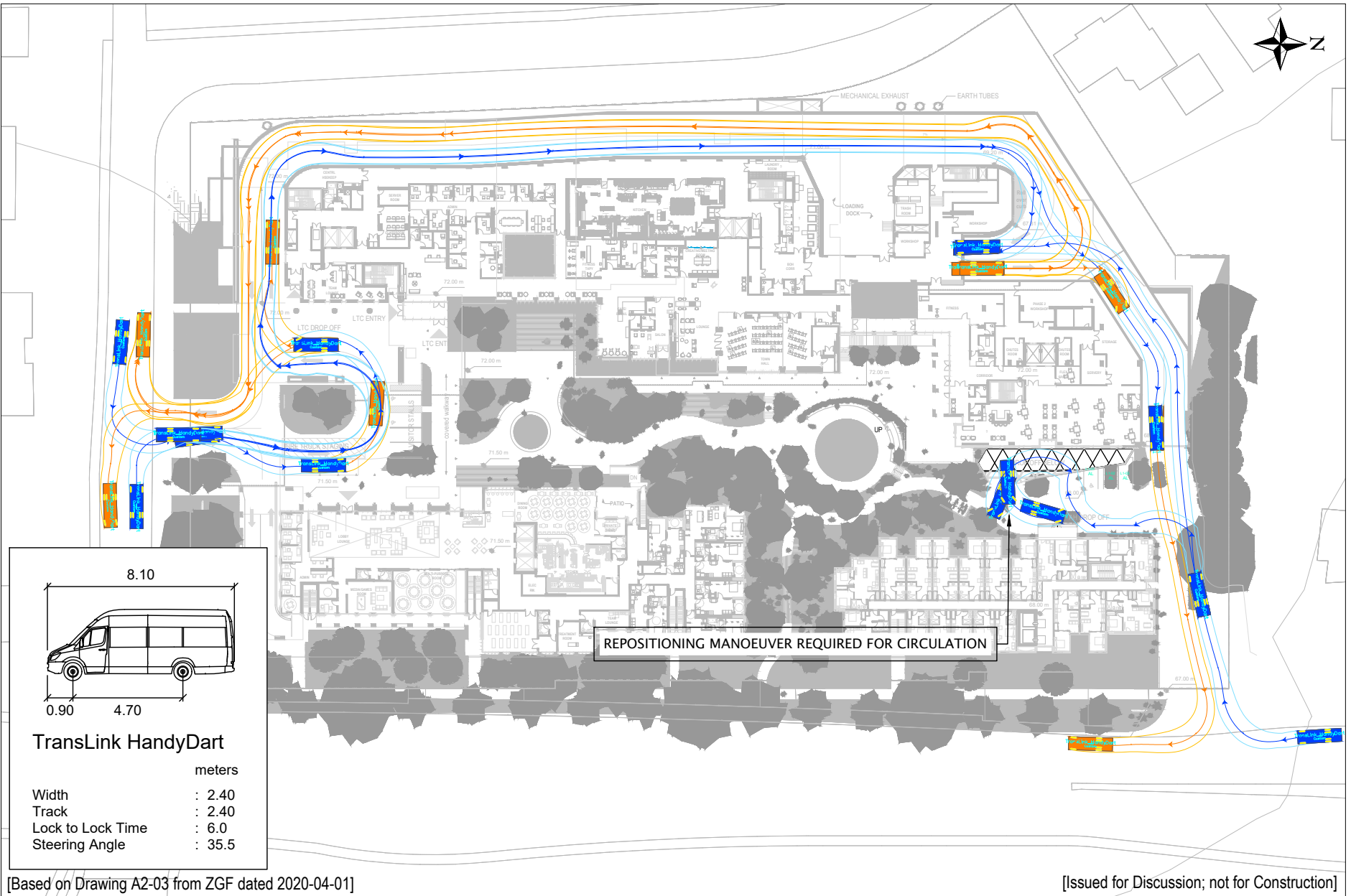

Exhibit 4.9 Handy Dart Site Access



M:\Operations\Dept BC\Projects\2020\04-20-0028 Inglenwood Care Centre Pre App\4.0 Analysis & Design\4.1 ACAD\1. Overall Site Design\04-20-0028_Inglenwood - Site Design Review_AT_V02-1.dwg
 2021/09/23 1:5:00, Plotted by Nathan Birk

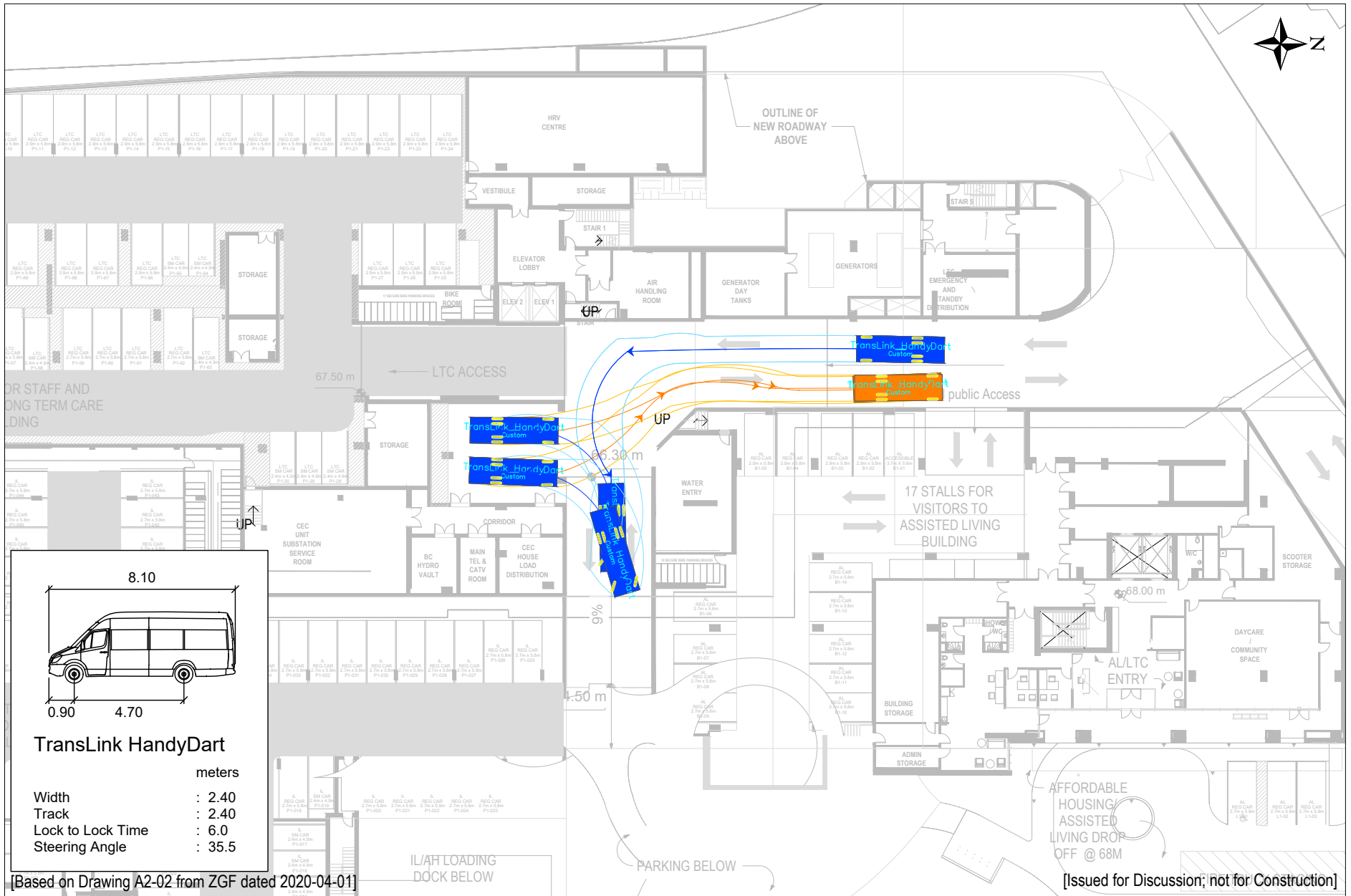

Exhibit 4.10 Handy Dart Level P1 Manoeuvres



M:\Operations\Dept BC\Projects\2020\04-20-0028 Inglewood Care Centre Pre App\4.0 Analysis & Design\4.1 ACAD\1. Overall Site Design\04-20-0028_Inglewood - Site Design Review_AT_V02-1.dwg
 2021/09/23 15:00, Plotted by Nathan Birk

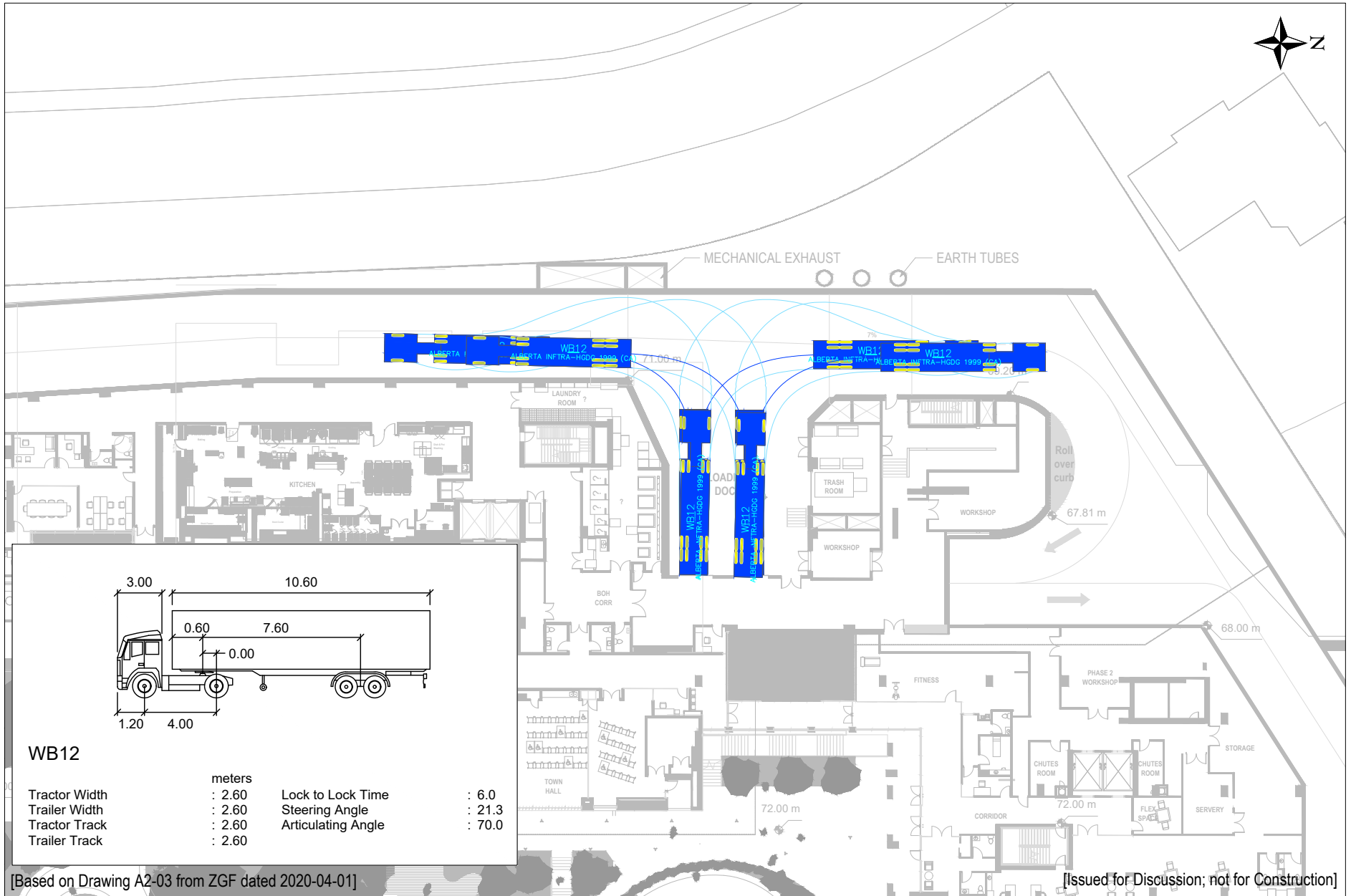

Exhibit 4.11 Level 1 WB12 Inbound Loading Manoeuvres

